



Defense Information Systems Agency
A Combat Support Agency

**Defense Information Systems Agency
Joint Interoperability Test Command
Fort Huachuca, Arizona**



Visitor Information Packet

Postal Address

Joint Interoperability Test Command
P.O. Box 12798
Fort Huachuca, AZ 85670-2798

Visitor Support Center

Commercial: 520-538-5508
DSN: 879-5508

1-800-LET-JITC (538-5482)

DSN: TRY-JITC (879-5482)

JITC

***Unparalleled Value-Added to the WARFIGHTER
The BATTLEGROUND should never be the TESTING GROUND***



JITC Visitor Information Packet

MISSION	2
VISION	2
JITC'S UNIQUE ROLES	2
HISTORY.....	3
CONTACT INFORMATION	4
JITC CLEARANCE INSTRUCTIONS	5
PROPERTY PASSES.....	6
MAPS AND DIRECTIONS.....	7
Map from Tucson International Airport.....	7
Directions to JITC from the Van Deman and Buffalo Soldier Gates.....	8
Map of Fort Huachuca	9
LOCAL INFORMATION AND ATTRACTIONS	10
Garden Canyon, Fort Huachuca	10
The Old Post Cemetery, Fort Huachuca	10
Fort Huachuca Museum and Annex.....	11
The U.S. Army Military Intelligence Museum (MI Museum), Fort Huachuca	11
Reservoir Hill Overlook, Fort Huachuca.....	11
Kartchner Caverns State Park	12
Ash, Carr, Miller & Ramsey Canyons.....	12
Bisbee, Arizona.....	13
Tombstone, Arizona.....	14



MISSION

DoD's Joint Interoperability Certifier and only non-Service Operational Test Agency for Information Technology (IT)/National Security Systems. JITC provides risk based Test, Evaluation & Certification services, tools, and environments to ensure Joint Warfighting IT capabilities are interoperable and support mission needs.

VISION

Experts in testing and certification, accelerating the Nation's IT dominance.

JITC'S UNIQUE ROLES

- **Joint Interoperability Certifier** – Throughout the acquisition process, JITC assists in identifying joint interoperability requirements, and ensures interoperability is built into the system from the start. JITC aides in the most efficient use of resources, and also assists in identifying solutions to interoperability problems necessary to get the system certified.
- **Operational Test Agency (OTA)** – As an Operational Test Agency (OTA) JITC is responsible for planning and conducting operational tests, reporting results, and providing an evaluation of each tested system's operational effectiveness, suitability, interoperability, and security. JITC is the OTA for Information Technology (IT) and National Security Systems (NSS) acquired by the Defense Information Systems Agency, other Department of Defense (DoD) organizations, and non-DoD entities.
- **Warfighter Joint and Coalition Interoperability Support** – JITC provides direct technical and regulatory interoperability support to the Combatant Commanders, Services, and DoD Agencies (CSAs) during the planning and execution of joint/combined operations and exercises in order to identify and resolve emerging and systemic interoperability issues. JITC also maintains 24/7 Hotline support to help resolve immediate Warfighter interoperability issues. JITC's Hotline service is usually available at no cost to the military services, government agencies, and government sponsored contractors.
- **Major Range and Test Facility Base (MRTFB)** – JITC is the only non-service Major Range Test Facility Base, servicing the DoD Chief Information Officer (DoD CIO). As such, JITC is considered a national asset. Services that are provided include Test and Evaluation (T&E) Capabilities, Infrastructure, and Resources to support the DoD acquisition system.

HISTORY

In 1988, the Defense Communications Agency (DCA) absorbed the Tri-Service Tactical Communications (TRI-TAC) Joint Test Element (JTE) and the Joint Tactical Command, Control, and Communications Agency (JTC3A) Joint Interoperability Test Facility (JITF). DCA consolidated these organizations in 1989 to form the “Joint Interoperability Test Command (JITC)” in Fort Huachuca, Arizona. JITC’s primary mission was to provide interoperability compliance testing and certification.

As the designated lead for DoD Command, Control, Communications and Intelligence (C3I) support, DCA tasked JITC to perform interoperability tests of various systems including High Frequency (HF) radio systems, Military Satellite Communications (MILSATCOM) systems, and the Worldwide Military Command and Control System (WWMCCS).

In 1992, DCA was renamed “Defense Information Systems Agency (DISA)” to reflect its expanded role in managing the Defense Information Infrastructure (DII), now known as the Global Information Grid (GIG). As a result, JITC’s responsibilities for ensuring joint interoperability of all military systems began to increase as well, causing the need for growth and expansion within the organization. In 1992, JITC was also designated a member of DoD’s MRTFB to provide test and evaluation services to all of DoD, other federal agencies, state and local governments, and private industry.

In 1993, the Naval Computer and Telecommunications Command (NCTC) proposed an initiative to transfer the functions and resources of the Naval Telecommunications Systems Integration Center (NAVTELSYSIC) to JITC. Since 1976, the NAVTELSYSIC test facility operated out of Cheltenham, Maryland, and was the primary site for the Quality Assurance (QA) and Functional Certification testing of all Navy messaging systems. DISA and the Chief of Naval Operations (CNO) agreed that the transfer of NAVTELSYSIC resources to JITC would improve both agencies’ ability to enhance operational fleet support. Thus, JITC’s east coast arm, known as the Washington Operations Division, was established. In 1998, the Washington Operations facility was moved to the Naval Surface Warfare Center (NSWC) at Indian Head, Maryland.

In 2006, JITC established a test group at the DISA facility in Falls Church, Virginia to support the fielding of global-net-centric solutions by providing continuous and effective T&E services to DISA joint acquisition programs within the Enterprise Services construct.

In 2010, the DISA T&E Executive dissolved the Test & Evaluation Management Center (TEMC) and transferred the responsibility of managing all DISA T&E laboratories and test beds to JITC. This included the physical move of T&E assets from the Falls Church facility to Fort Meade, Maryland in April 2011, as part of the Base Realignment and Closure (BRAC).

Today, testers at all JITC facilities work in concert to provide a seamless test capability in support of the warfighter.

JITC Visitor Information Packet

Contact INFORMATION

Visitor Support Center: disa.huachuca.jitc.mbx.command-support-team-cst@mail.mil

COMM: (520) 538-5508

DSN: 879-5508

COMM: (520) 538-2608

DSN: 879-2608

COMM: (520) 538-5475

DSN: 879-5475

Physical Address:

Joint Interoperability Test Command

Attn: JT1A

2001 Brainard Road, Building 57305

Fort Huachuca, AZ 85670-2798

1-800-LET-JITC (538-5482)

DSN: TRY-JITC (879-5482)

FAX Number: (520) 538-2380

Helpful URLs:

- JITC – <http://jitc.fhu.disa.mil/>
- Fort Huachuca – <http://huachuca-www.army.mil/>
- Fort Huachuca IHG Army Hotels - <http://www.ihg.com/armyhotels/hotels/us/en/reservation>
- Sierra Vista Convention and Visitor's Bureau – <http://www.visitsierravista.com>
- City of Sierra Vista, Arizona – <http://www.sierravistaaz.gov>

Lodging Near Tucson International Airport

The following URL lists all the hotels within 20 miles of TIA.

<http://www.hotels-rates.com/hotels/locations/Tucson/AZ/usa/198/>

MAPS AND DIRECTIONS

PLEASE NOTE: The hotel, restaurant, and business information contained in this information packet is for general information purposes only. Reference to any specific commercial service by trade name, trademark, manufacturer, or otherwise, does not constitute or imply endorsement, recommendation, or favoring by the Joint Interoperability Test Command, its employees, or the United States Government.

Please also note that the maps included in this document are not to scale. They are meant to be a guide only.

JITC Visitor Information Packet

JITC CLEARANCE INSTRUCTIONS

The following information can also be found using this URL:

http://jitc.fhu.disa.mil/organization/contactUs/local_info/downloads/citizenvisitfhu.pdf

1. Collateral clearance information can be sent by JPAS or Fax.

a. JPAS Visit Notifications:

- (1) SMO: DKARAA
- (2) POC: JITC/Individual's Name

b. Faxed Visit Authorization Letters:

- (1) Site to be visited and contact numbers:

Mailing Address:

Joint Interoperability Test Command
Attn: Security Office
P.O. Box 12798
Fort Huachuca, AZ 85670-2798

Facsimile Numbers

Comm: (520) 538-4345
DSN: (312) 879-4345

Voice Numbers

Comm: (520) 538-5200
DSN: (312) 879-5200

(2) The following information is required on the Visit Authorization Letter.

- Name
- SSN
- Citizenship
- Eligibility level and date (An example of clearance level and date would be a SECRET clearance granted on ddmmmyy (03 Jul 08).)
- Type of investigation and date (An example of investigation type and date would be an SSBI dated ddmmmyy (03 Jul 08).)
- Purpose of visit
- Date of birth
- Place of birth
- POC at the JITC
- Length of visit (maximum 1 year)
- Signature block of your security manager

(3) Contractors using the Visit Authorization Letter must submit them through their responsible Facility Security Officer (FSO) IAW DoD 5220.22-M, chapter 6-103. All requests must be submitted on your company or organization letterhead, signed by your FSO and faxed to the above stated number.

****Do not print this page and fill in your pertinent information, as we will not accept it.****

2. **SCI visit certifications must be sent via JPAS SMO Code DKARAA3 or by messaging to PLA "SSO DISA" PASS TO JITC FH SSR.** Do not use this JPAS SMO Code or PLA for collateral (Secret or Top Secret) security clearances. For questions concerning SCI visit certifications please contact the JITC Special security Representative at (520) 538-4181

3. DISA visitors: please notify the JITC Security Office via e-mail of your visit and we will have a badge ready for you upon your arrival. disa.huachuca.jitc.list.security-office@mail.mil

JITC Visitor Information Packet

PROPERTY PASSES

Visitors who hand carry property into JITC work sites must enter through the main lobby entrance, and fill out a temporary Individual Property Pass (IPP) form issued by a Security Officer or Visitor's Support Representative (VSR) at the time of arrival. If prior coordination has been established the form can be sent to the visitor prior to arrival by the VSR.

The form will be completed by the visitor at the security desk and signed by the visitor escort before the visitors enters the facility.

Property Passes from originating DoD Units will also be acceptable at JITC-FHU. The form must remain visible on the equipment while in use at JITC-FHU.

OPTIONAL FORM 7 SEPTEMBER 1988 PRESCRIBED BY GSA FPMR (41 CFR) 101-20.110	<h3 style="margin: 0;">PROPERTY PASS</h3>	1. DATE ISSUED <div style="border: 1px solid black; height: 20px; width: 100%;"></div>
This pass is to be used whenever property is removed from the building. It is to be properly filled in and signed and handed to the guard when leaving the building.		
2. NAME <div style="border: 1px solid black; height: 20px; width: 100%;"></div>	3. BUILDING <div style="border: 1px solid black; height: 20px; width: 100%;"></div>	
4. DESCRIPTION OF PROPERTY BEING REMOVED <div style="border: 1px solid black; height: 30px; width: 100%;"></div>		
5. PROPERTY BELONGS TO <div style="border: 1px solid black; height: 20px; width: 100%;"></div>	6. DEPARTMENT OR AGENCY <div style="border: 1px solid black; height: 20px; width: 100%;"></div>	
7. SIGNATURE OF PERSON AUTHORIZING REMOVAL OF PROPERTY <div style="border: 1px solid black; height: 20px; width: 100%;"></div>	8. TITLE <div style="border: 1px solid black; height: 20px; width: 100%;"></div>	
9. PASS GOOD UNTIL <div style="border: 1px solid black; height: 20px; width: 100%;"></div>		
NSN 7540-00-634-4264		

Map from Tucson International Airport to JITC

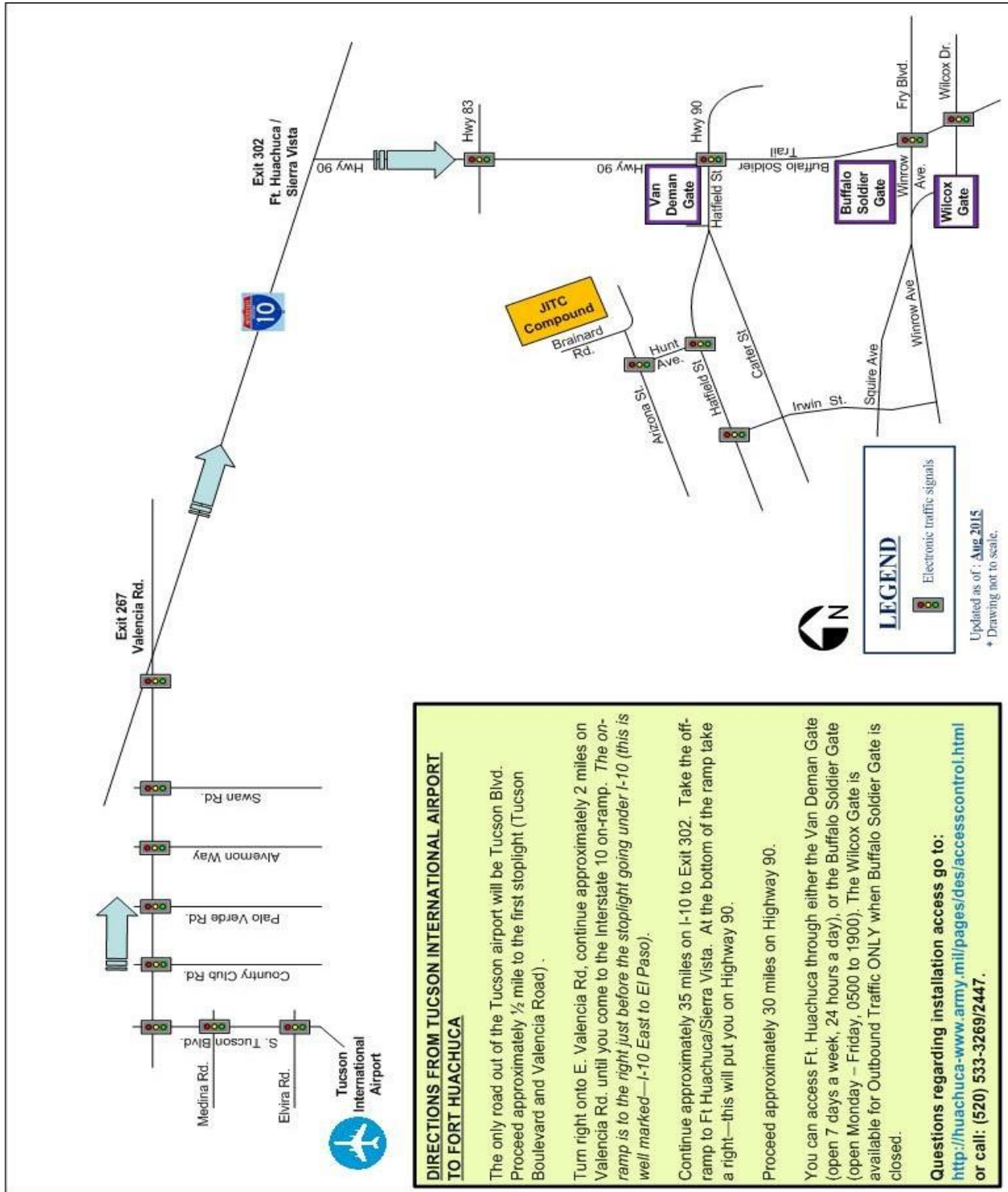

JITC Visitor Information Packet

Directions to JITC from the Van Deman and Buffalo Soldier Gates

Van Deman Gate: 24 Hours (Intersection of Hwy 90 & Buffalo Soldier Trail)

Proceed through the gate on Hatfield. The 1st stoplight will be Hunt, turn right. Continue to the next stoplight which will be Arizona, turn right. Turn left on Brainard Rd. JITC is on the right, Building # 57305, 2001 Brainard Rd.

Buffalo Soldier Gate: 0500 to 1900 (Monday-Friday) (Intersection of Fry Blvd & Buffalo Soldier Trail)

Proceed through the gate on Squire Ave heading west, turn right at stoplight onto Irwin. At the stoplight, turn right onto Hatfield. The second stoplight will be Hunt, turn left. The next stoplight will be Arizona, turn right. Turn left on Brainard Rd. JITC is on the right, Building # 57305, 2001 Brainard Rd.

Questions regarding installation access go to

<http://huachuca-www.army.mil/pages/des/accesscontrol.html> or call: (520) 533-3269\2447

JITC Visitor Information Packet

Map of Fort Huachuca

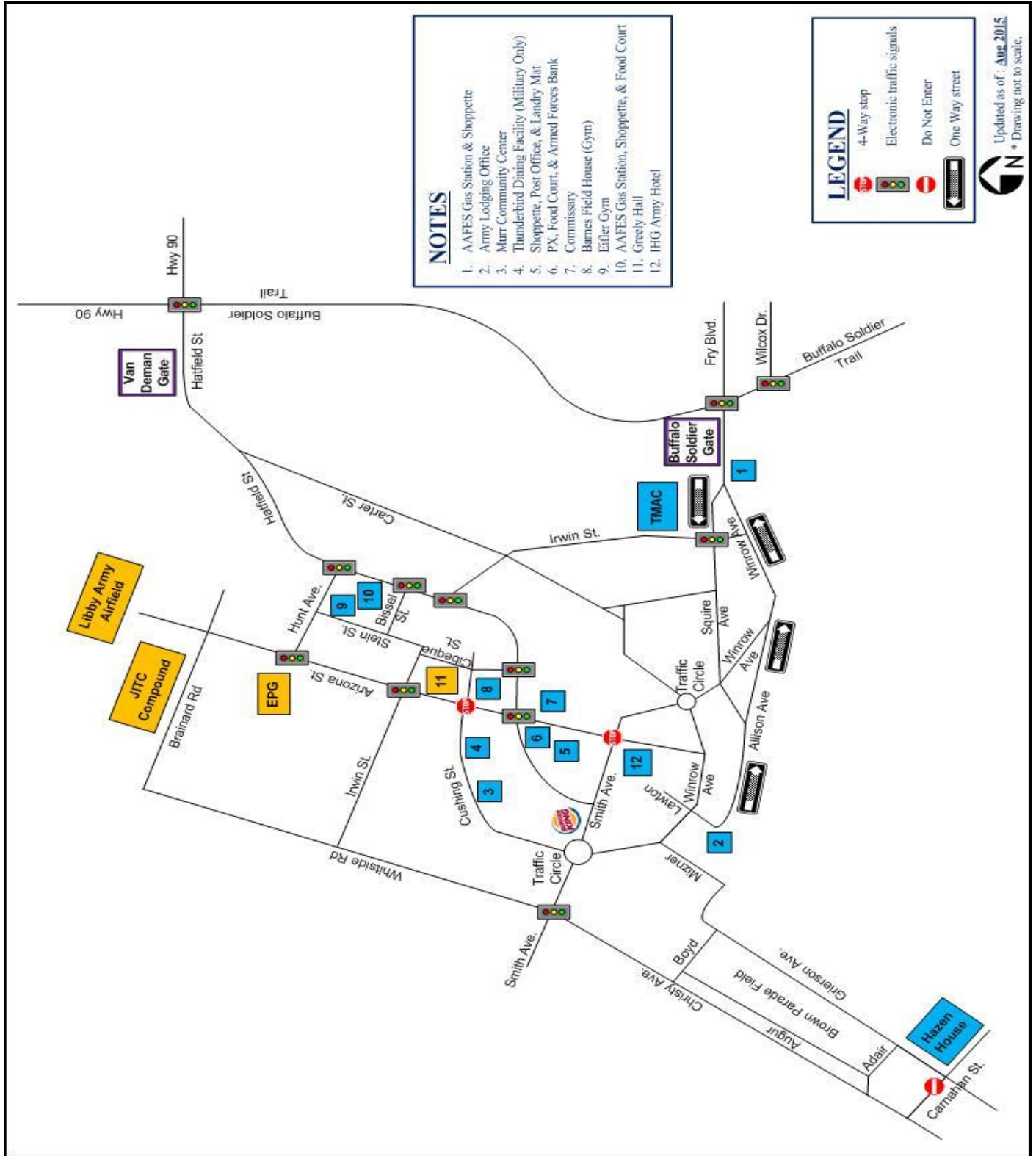

LOCAL INFORMATION AND ATTRACTIONS



Garden Canyon, Fort Huachuca

A must hike for naturalists, birders, butterfly enthusiasts and archaeology buffs. Inhabited since 600 A.D., the Canyon has 53 pictographs, or rock art, from some of its earliest residents, as well as Apache pictographs from the 1700s. The canyon is easily and fully accessible from hiking trails winding through some of the most diverse flora and fauna.

Here white-tailed and mule deer, pronghorns and javelinas roam. Birders should keep an eye out to add Sulphur - bellied Flycatchers, Painted Red Start and Elegant Trogons to their life lists. The Scheelite Canyon Trail yields Mexican Spotted Owls; and the Sawmill Canyon Trail is a haven for Montezuma Quail, Buff-breasted Flycatchers as well as Red-faced and Grace's Warblers.

From the Fort Huachuca Main Gate, follow Squire Ave. 2 miles to the Garden Canyon sign on left; continue to Range Control; right on Range Road to Garden Canyon.



The Old Post Cemetery, Fort Huachuca

See history immortalized on gravestones. Before the end of the Post's first year in 1877, the 6th Cavalry troopers suffered their first casualty and established the need for memorial grounds.

The Old Post Cemetery is an emotional "read" for devotees of military history. Historic characters abound. Take postmistress Mrs. Carrie Clark, who was moved lock, stock and post office from Post grounds because she was disrespectful of the Post commander. Or was it because she was selling illegal whiskey? Or experience the eerie, wind-swept quiet of the final resting place for 76 souls disinterred from Old Fort San Carlos, and a score more who met unkind fates in the Apache-terrorized wilderness beyond the Post gates. You would miss these graves if not for the lone headstone with the inscription, "The Unknowns."

From the Fort Huachuca main gate, follow Squire Ave. to Winrow; left onto Mizner; right onto Grierson; right onto Hungerford; left onto Christy; follow signs to the Old Post Cemetery.



Fort Huachuca Museum and Annex

There's nothing like the great indoors of our museums to shed light on history. Nowhere is this truer than in the Fort Huachuca Museum and its Annex. Interested in manuscripts over 140 years old? Or would you like to relive the edge-of-the-chair, nuclear confrontations of the Cold War? Opened in 1960, this extraordinary collection is housed in two large buildings, offering a panoramic and comprehensive exhibit of Southwestern U.S. history. From the first attempts to tame the territory in 1846, through the 4th Cavalry patrol and their Indian scouts' campaigns that resulted in the surrender of Geronimo, and to the battles of the Pacific during the "Big One" – it's all here in breathtaking detail. Be sure to allow at least a few hours to tour these exhibits of clothing, weaponry, and other rarities from the Buffalo Soldiers, the Civil War, World War II, and the Korean War.

From the Main Gate take Squire Ave. to Winrow; left onto Mizner; right onto Grierson; right onto Hungerford; parking on the left.

The U.S. Army Military Intelligence Museum (MI Museum), Fort Huachuca

How is this for authenticity and relevance? The MI Museum of Fort Huachuca is such a complete storehouse of historic significance that the U.S. Army Military Intelligence School uses it extensively to this day. Be sure to reserve about an hour to fully enjoy these deviously clever exhibits.

Visitors will see surveillance and espionage tools from the Civil War, the notorious Enigma Machine coding device used by the Germans during WW II, one of our Cold War espionage jeeps, a surveillance drone and, the real thing, a 12' x 10' section of the Berlin Wall, replete with graffitied political statements.

From the Main Gate take Squire Ave. to Winrow; left onto Mizner; right onto Grierson; right onto Hungerford; parking on the left.

Reservoir Hill Overlook, Fort Huachuca

In 1883, Captain Adna R. Chaffee, the Post Commander, plagued by a water supply problem, ordered a 200,000-gallon capacity double reservoir built on a hill just east of Fort Huachuca. Over time that hill became known as both Reservoir Hill and Signal Hill. Located on the southern portion of the overlook on Fort Huachuca on a small patch of terrain extending from the hill, the U.S. Army Signal Corps discovered this vantage point for sending heliograph messages to other stations throughout the area. This is truly the majestic viewpoint of the San Pedro Valley.

From the Main Gate, take Squire Ave. to Winrow; left on Mizner; right onto Grierson toward Huachuca Canyon. Just before Huachuca Canyon, take a left and follow the road to Reservoir Hill.



Kartchner Caverns State Park

In November of 1974 two local cavers were exploring around the base of the Whetstone Mountains when they noticed a narrow opening leading into the hillside. They followed the opening, crawling until they entered a vast, pristine cavern. The two kept their discovery secret from even the property owners, James and Lois Kartchner, until four years later. The cave's existence was not publicly revealed until 1988, when the site was sold and designated as an Arizona State Park. What will you find within this carefully protected and preserved land of visual enchantment below the ground? Stunning living caverns of mystery and awe, including exhibits of scientific information on why these internationally acclaimed caverns exist. You'll learn about the bats that make their home here, and how the many huge stalactites and stalagmites are formed. And you will see why Kartchner Caverns is truly an underground phenomenon unlike any other. Amenities include shaded ramadas and outdoor picnicking. The Discovery Center offers interactive displays and a theater video program. Walking and hiking trails and a campground are available.

Hwy 90 North 19 miles to the park gate on left.



Ash, Carr, Miller & Ramsey Canyons

Where else would four publicly accessible canyons that also happen to be world renowned bird watching sites end up in the same locale?

In Ramsey Canyon, the public can watch hummingbird research banding of the 14 species generally migrating through and in Miller Canyon, 17 hummingbird species have been sighted, along with the indigenous Leopard Frog. Rare bird sightings in these canyons, like the Plain-capped Star Throat, Flame-colored Tanager and the Slate-throated Red Start, have garnered national attention.

The Carr House Visitor Center in Carr Canyon offers displays and exhibits of historical and natural significance. There are nature trails for strolling as well as hiking that is more adventurous. These four canyons offer trailheads that lead into the majestic Coronado National Forest and Miller Peak, with its breathtaking views at nearly 10,000 feet.

Visit the public bird feeding stations at the Ash Canyon B&B in Ash Canyon as well as those at Beatty's Guest Ranch & Orchard in Miller Canyon.

Follow Highway 92 South for six miles then turn right on Ramsey Canyon Road. The preserve is at the end of Ramsey Canyon Road, four miles west of the highway.



JITC Visitor Information Packet



Bisbee has evolved into an attractive artist colony and retirement community, known for its relaxed quality of life. Travelers from all over the world come to Bisbee to savor its unique charm... an uncommon blend of creativity, friendliness, style, romance and adventure — all wrapped in the splendor of the Old West. To stop in Bisbee is to stop in time. Nestled in the mile-high Mule Mountains of southern Arizona, Bisbee has maintained an Old World charm seldom found anywhere in the United States.

The fine collection of well-preserved turn of the century Victorian structures is full of old west history and copper mining lore. Old miners' boarding houses have been refurbished into many charming small bed and breakfast establishments, of which no two are alike. Former saloons are now quaint shops, antique stores or art galleries, cafes and restaurants.

Come stay in Bisbee. Stroll its sidewalks and find delight in the many art galleries, gourmet restaurants, coffee houses, book stores and specialty shops. Visit the charmingly restored neighborhoods of Victorian and European-style homes perched miraculously on the hillsides. Unwind...relax...and find soothing respite from your everyday world.

The most popular activity in Bisbee is the Queen Mine Tour, a trip down into the now inactive copper mine. Bisbee's Queen Mine was once one of the richest copper mines in history when the mine originally opened in 1877. The mine eventually closed when mining operations were discontinued in Bisbee in the mid-1970s. The Queen Mine opened once again as a tour for visitors in 1976, nearly 100 years after the mine originally opened. Visitors don yellow slickers, hard hats, and miner's lanterns as they descent on the mine train deep into the mine and experience the life of miners as they toiled in the subterranean tunnels.

A must for history buffs is a visit to the Bisbee Mining & Historical Museum, the West's first rural Smithsonian Institute affiliate. At the museum, visitors learn more about life on Bisbee's "Urban Frontier". Also a stop at the historic Muheim House is important for an outstanding example of 19th century architecture and elegance.

Another popular activity is Bisbee's excellent self-guided historic walking tour. A brochure of the walking tour can be picked up at the Visitor Center. The tour details each historic structure and guides the visitor with a map.

For more information visit <http://www.cityofbisbee.com/>

The Town too Tough to Die



Tombstone is located 22 miles South of I-10 on Hwy 80, which is 67 miles Southeast of Tucson. The current population is roughly 1,500 and the elevation is 4,540. While visiting Tombstone, tourists will find themselves stepping back into the past as they witness re-enactments at the OK Corral or take a stroll along the boardwalks on Allen Street where they might want to unwind and relax in The Bird Cage Theater, Big Nose Kate's or The Crystal Palace, some of Tombstone's best known tourist attractions and saloons. The surrounding mountains and communities in Cochise County offer visitors much insight into America and Arizona's history. Visitors to the area will find themselves captivated by the surrounding mountain ranges, such as the "boulder like" Dragoon Mountains. The town site of Tombstone (a name invented by Edward Schieffelin) was laid out on March 5, 1879. At that time Tombstone had 40 cabins and 100 people. Allen Street lots sold for \$5.00 each. By June 20, 1880 there were 3,000 people in town. By late 1881 there was over 7,000 people in town and more gambling houses, saloons, and a larger "boothill" and "red light" district than any town in the Southwest. Population increased rapidly from that time, and in the 1890s it had reached a maximum of 15,000. Although Tombstone started as a mining camp, today tourism is the primary industry.

Boothill Graveyard is known throughout the world as the final resting place of the Wild West's most legendary characters. The Clanton's and Mc Laury's, Bill Claiborne, Billy Grounds, China Mary, Dutch Annie, Quong Kee, Red River Tom and dozens of other famous and infamous are buried here.

The OK Corral is home to the most famous historic gunfight in the Old West. Wyatt Earp with his brothers Virgil and Morgan along with Doc Holliday, trying to instill peace in the rowdy town of Tombstone, fought it out with the Clanton and McLowry brothers at the rear entrance to the OK Corral. The infamous gunfight of October 1881 went down in history and is re-enacted daily at 2:00pm on the streets of Tombstone.

The Bird Cage Theatre was one of the most famous "honky-tonks" in America in the years 1881 to 1889. The New York Times referred to it in 1882 as the "wildest, wickedest night spot between Basin Street and the Barbary Coast".

The Rose Bush located in the Rose Tree Inn Museum, was planted in 1885 from a rooted Lady Banksia Rose shoot sent from Scotland. In the 1930s Robert Ripley from Ripley's Believe It or Not visited the Museum and in his column declared the rose bush the World's largest Rose Tree. For more information visit <http://www.tombstone.org/>